



Public consultation on the Revision of the EIB Transport Lending Policy

Waterborne (inland and maritime) transport

Breakout 2: 11h15 – 12h30

Thursday 14 October 2021

EIB panel (Projects directorate – Mobility Department)



Ismini Kyriazopoulou
Head of the Air, Maritime & Innovative Transport Division



Tom Scheltjens
Economist,
Air, Maritime &
Innovative Transport
Division



Txema Urrutia Aldama
Engineer,
Air, Maritime & Innovative
Transport Division



Sotirios Basiacos
Engineer,
Air, Maritime & Innovative
Transport Division



Panagiotis Markoulidis
Senior Transport Specialist
Advisor, Strategic Transport
Advisory Division

How to participate in the discussions - Slido

- Go to **sli.do** on your browser and insert the code **#TLP**
- After the presentation, “raise your hand” and the moderator will give you the floor



You can “like” other people’s questions and comments to give them priority!



My name (and organisation)

2:26 PM

This is my comment



The slides and a summary of the discussion will be made available on our consultation webpage

Revision of EIB Transport Lending Policy

Public consultation event: Waterborne

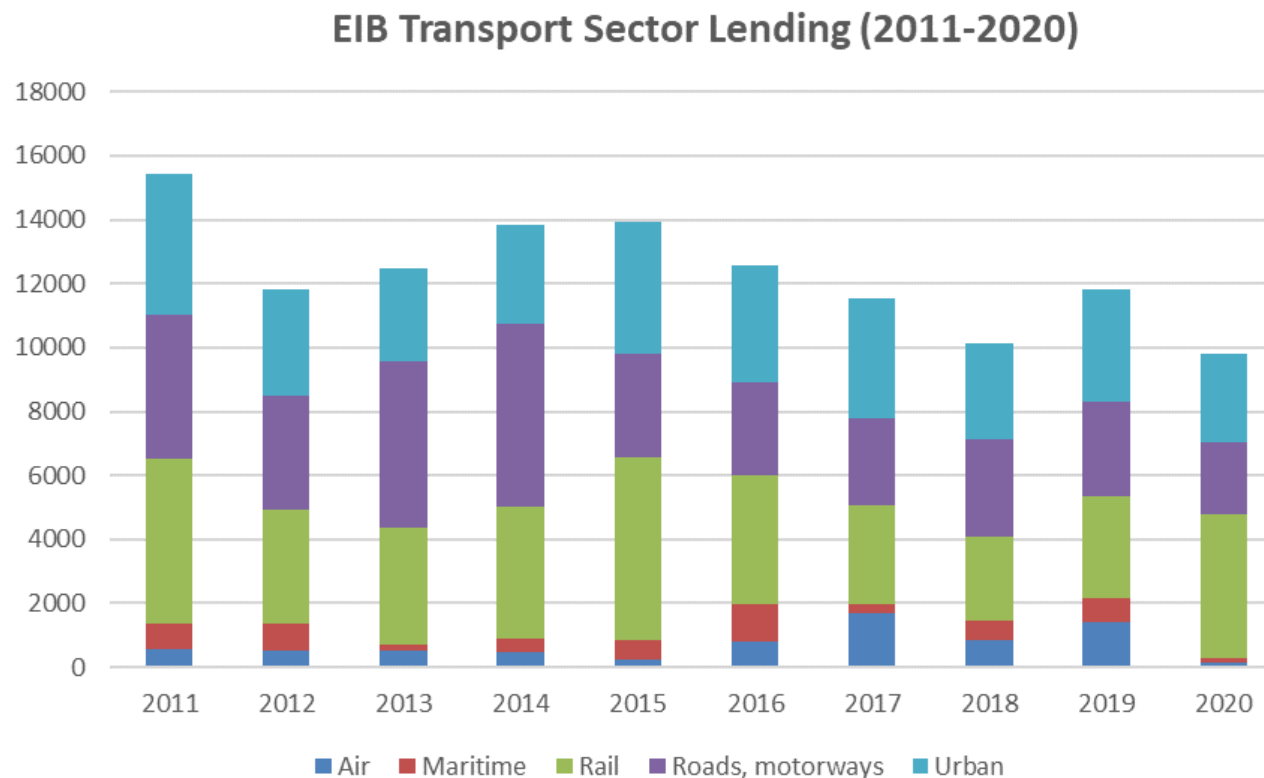

Revision of EIB Transport Lending Policy

Public consultation event: Waterborne

- **2011-2020 : EIB support to ports**
 - ❖ Existing ports - rehabilitation/expansion of common user infrastructure
 - ❖ Breakwater, access channel, maritime locks, capital dredging, navigation aids, quay walls, etc.
 - ❖ Environmental compliance components
 - ❖ Alternative fuels infrastructure
 - ❖ Development of new terminals
 - ❖ Basic terminal infrastructure
 - ❖ Superstructure and equipment
 - ❖ Development of new ports
 - ❖ Improvement of hinterland transport connections

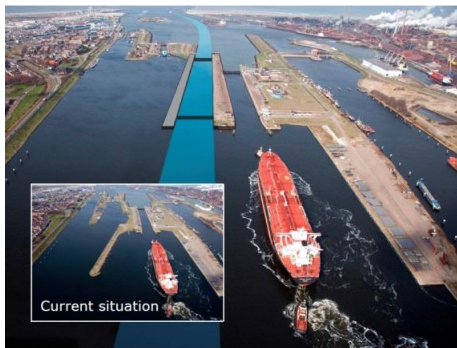

Revision of EIB Transport Lending Policy

Public consultation event: Waterborne

- 2011-2020 : EIB support IWW
 - ❖ Waterways, locks, quay walls, RIS, etc.
 - ❖ Inland ports
- 2011-2020 : EIB support shipping
 - ❖ Construction of new vessels
 - ❖ Retrofitting of existing vessels
 - ❖ Shipbuilding RDI programmes



Revision of EIB Transport Lending Policy

Public consultation event: Waterborne

Four pillars underpin the vision for the new Transport Lending Policy



SAFE - A safe system that prevents unnecessary loss of life, and protects users from attack, discrimination or harassment.



ACCESSIBLE - An affordable and accessible network available to all who can benefit from the opportunities it provides.



GREEN - A clean and carbon-neutral system that does no significant harm to the environment.



EFFICIENT - A smart and efficient system that achieves its benefits by utilising technology to minimise the use of resources and prevent congestion.

Transport
Lending Policy
2011

Transport in
Climate Bank
Roadmap

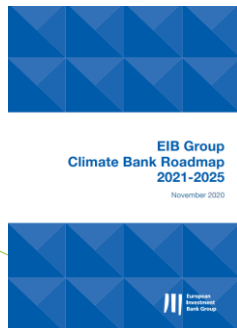

EC's Sustainable and
Smart Mobility
Strategy

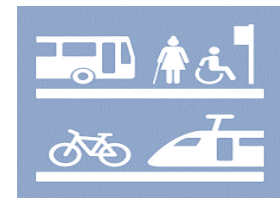

Transport
Lending Policy
2022



There are many topics to discuss today. We are here to listen! Here are some topics...

Please share your views...

Key investment needs
(inside and outside EU)

Roadmap to
decarbonisation

Resilience challenge

How to participate in the discussions – raise hands

- **Indicate that you wish** to speak
- **Wait for the cue** from the moderator, who will call out your name
- Remember to **lower your hand** if you no longer wish to speak

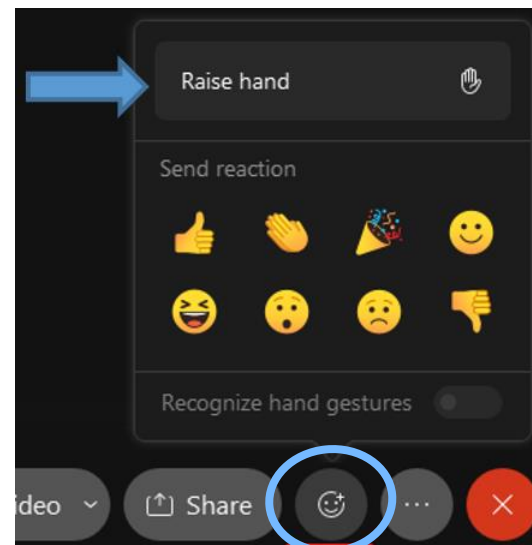
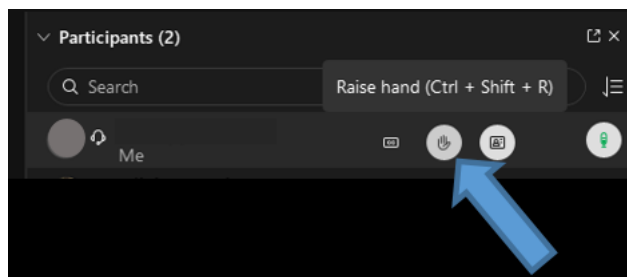

EIB panel (Projects directorate – Mobility Department)



Ismini Kyriazopoulou
Head of the Air, Maritime & Innovative Transport Division



Tom Scheltjens
Economist,
Air, Maritime &
Innovative Transport
Division



Txema Urrutia Aldama
Engineer,
Air, Maritime & Innovative
Transport Division



Sotirios Basiacos
Engineer,
Air, Maritime & Innovative
Transport Division



Panagiotis Markoulidis
Senior Transport Specialist
Advisor, Strategic Transport
Advisory Division

There are many topics to discuss today. We are here to listen! Here are some topics...

Please share your views...

Key investment needs
(inside and outside EU)

Roadmap to
decarbonisation

Resilience challenge

Thank you!

- Join us for the next session @ **13:30** to discuss the **Technology** or **Accessibility**
- Submit your contribution before **29 October**
- Email us with your outstanding questions at tlpconsultation@eib.org

All information is available on our consultation hub (consult.eib.org).